

Cooling Fans

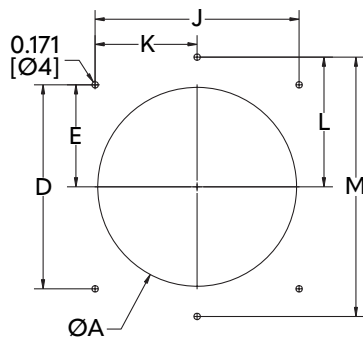

Your Enclosure Source®

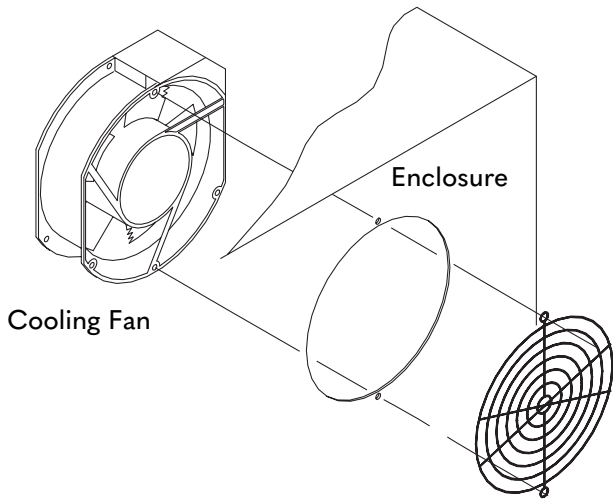

Finger Guard

One Finger Guard is Included.
An additional Finger Guard may be mounted on either side of the fan for maximum safety.

Performance Curve for 4.00" [102] Fan

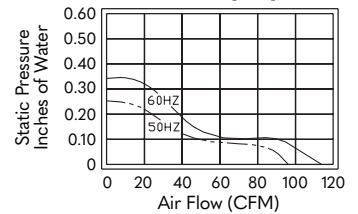

Performance Curve for 6.00" [152] Fan

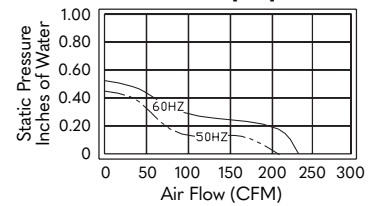

Performance Curve for 10.00" [254] Fan

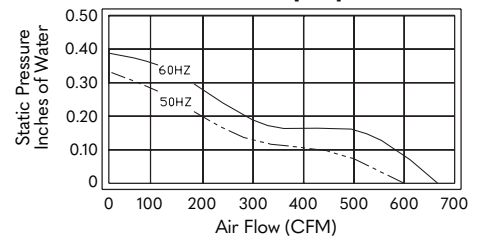

Mounting Cutout Dimensions

Catalog Number	CFM	Watts	Voltage	Hz	Line Amps	Motor RPM	Service Temp °F (°C)	Noise SIL (dB)
SCE-CF4	115	23/20	115 V	60	0.19	2600/3000	140 (60)	41/44 dB
SCE-CF6	238	47/41	115 V	60	0.25	2700/3000	140 (60)	51/55 dB
SCE-CF10	550	72/75	115 V	60	0.29	1400/1650	140 (60)	52/55 dB
SCE-CF4-230	115	23/20	230 V	60	0.09	2600/3000	140 (60)	41/44 dB
SCE-CF6-230	238	47/41	230 V	60	0.12	2700/3000	140 (60)	51/55 dB
SCE-CF10-230	550	72/75	230 V	60	0.14	1400/1650	140 (60)	52/55 dB

Catalog Number	ØA	D	E	J	K	L	M	Finger Guard
SCE-CF4	4.62 [117]	4.12 [105]	2.06 [52]	4.12 [105]	2.06 [52]			SCE-GARD4
SCE-CF6	5.88 [149]					3.19 [81]	6.38 [162]	SCE-GARD6
SCE-CF10	9.00 [229]	6.88 [175]	3.44 [87]	6.88 [175]	3.44 [87]			SCE-GARD10

Life Expectancy - 70,000 Hours minimum @ 25°C
Operating Temperature -10°C ~ +65°C / 66%